

Features:

- High bandwidth
- Flexure guides for zero-play movement
- Low noise closed-loop controller
- High rigidity, suitable for heavy mirrors
- Temperature stability

Applications:

- Laser beam steering, pointing
- Microscanning
- Line of sight stabilization
- Image stabilization
- Tracking

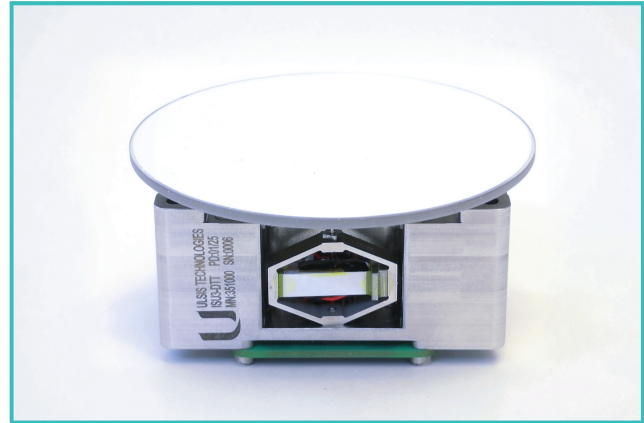

FSM-2000U

Specifications:

Max. Angular Stroke	2000 urad
Loaded Resonance Frequency (with 25 g quartz glass mirror)	>1500 Hz
Distance between pivot point and mirror surface	13 mm
Weight	280 g
Size	68x40x41 mm
Actuator Type	Multilayer Piezoactuator
Drive Voltage	150 V
Sensor	Strain Gauge
Resolution	> 12 bits
Cross-coupling	< 1%
Operating Temperature	-40 ... +70 °C

Note: This product is customizable for different sizes, strokes and frequencies.

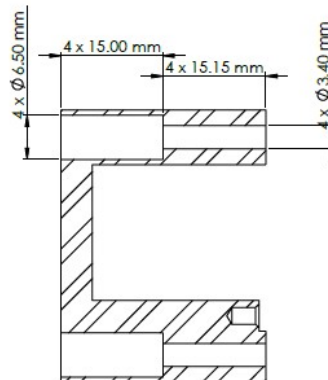
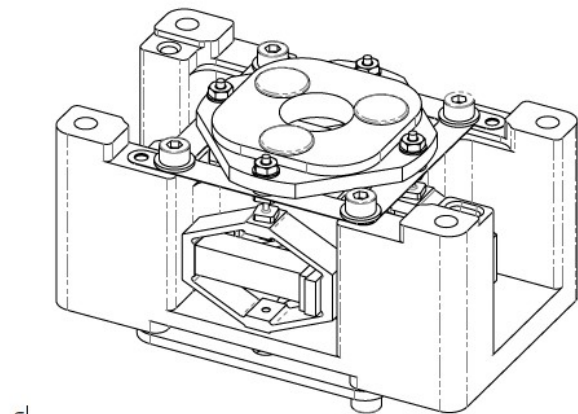
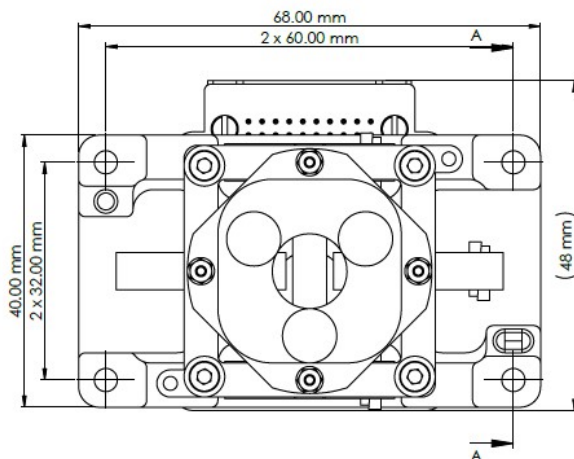
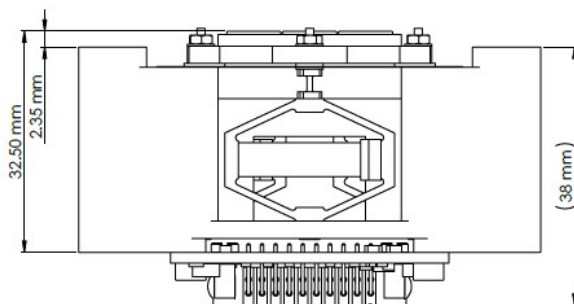

SECTION A-A
SCALE 2 : 1